

Plotted By: Willson, Teresa Sheet Set: BREWERY LAYOUT: C2.00 SIGNAGE AND MARKING PLAN July 11, 2023 05:52:49pm K:\FTL\CVN\044\Jobs\044203010-Cypress Nook\CAD\Plan\Sheet - Brew Fish Brewery\C2.00 SIGNAGE AND MARKING PLAN.dwg  
This document, together with the concepts and designs presented herein, as an instrument of service, is intended only for the specific purpose and client for which it was prepared. Reuse of and improper reliance on this document without written authorization and adaptation by Kimley-Horn and Associates, Inc. shall be without liability to Kimley-Horn and Associates, Inc.

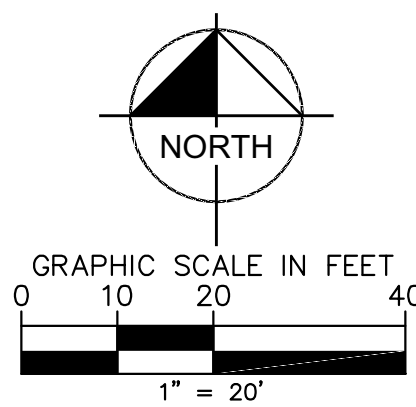
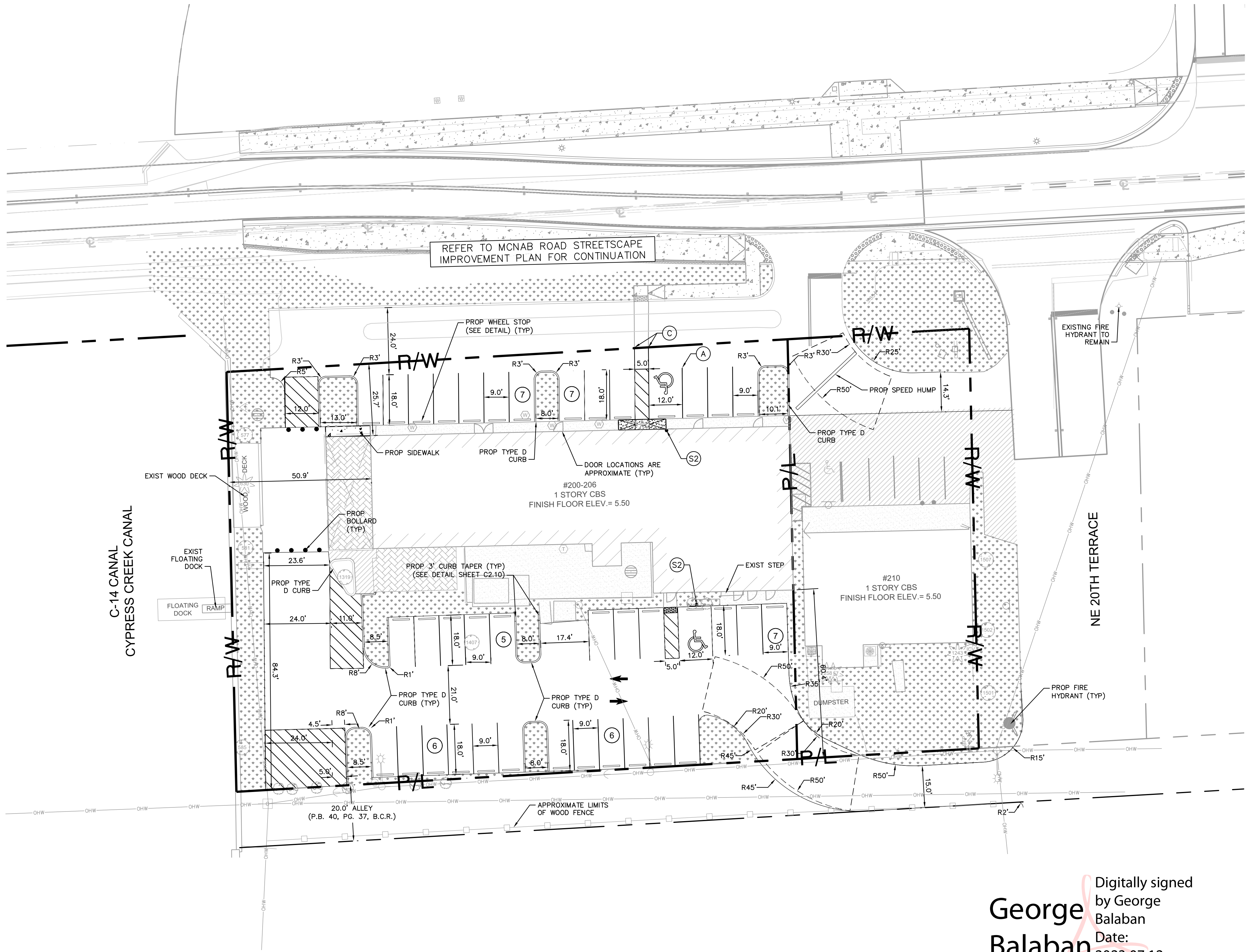

LEGEND

- CENTER LINE OF ROADWAY
- RIGHT-OF-WAY OR PROPERTY LINE
- EXIST BUILDING
- PROP TYPE "F" CURB AND GUTTER PER CITY OF POMPAHO BEACH STANDARD DETAIL ON SHEET C2.10
- PROP TYPE "D" CURB PER CITY OF POMPAHO BEACH STANDARD DETAIL ON SHEET C2.10
- PROP VALLEY GUTTER
- LANDSCAPING
- EXIST CONCRETE
- EXIST ASPHALT
- EXIST PAVERS
- PROP CONCRETE
- PROP PAVEMENT MARKINGS
- EXIST STREET LIGHT POLES

STRIPING KEY

- A = 6" SOLID WHITE
- B = 8" SOLID WHITE
- C = 12" SOLID WHITE
- D = 18" SOLID WHITE
- E = 24" SOLID WHITE
- F = 6" SKIP WHITE TYP (10'-30')
- G = 6" SKIP WHITE TYP (6'-10')
- H = 6" SKIP WHITE TYP (2'-4')
- I = 6" SOLID YELLOW
- J = 18" SOLID YELLOW
- K = 6" DOUBLE YELLOW
- L = 6" SKIP YELLOW TYP (10'-30')
- M = 6" SKIP YELLOW TYP (6'-10')
- N = 6" SKIP YELLOW TYP (2'-4')
- P = RPM BI-DIRECTIONAL AMBER/AMBER
- R = FDP WHITE
- S = FDP YELLOW
- T = RPM BI-DIRECTIONAL WHITE/RED
- U = RPM BI-DIRECTIONAL RED/YELLOW

SIGN LEGEND

- STOP
- FTP-20-4 12' x 18'
- FTP-22-4 12' x 18'
- FTP-22-4 12' x 18'
- FTP-22-4 12' x 18'

NOTES:

- CONTRACTOR SHALL REPLACE ALL STRIPING REMOVED AND/OR DAMAGED DURING CONSTRUCTION ALONG THE ROAD ABUTTING THE PROPERTY PER APPLICABLE CITY, COUNTY, AND/OR STATE STANDARDS.
- CONTRACTOR SHALL FIELD VERIFY THAT ALL EXISTING AND PROPOSED ADA ITEMS WITHIN PROJECT LIMITS (I.E., ROUTES, PARKING, STRIPING, SIGNAGE, ETC.) MEET THE MINIMUM REQUIREMENTS AND SHALL ADJUST ACCORDINGLY, BEFORE THE PROJECT CAN BE DEEMED CERTIFIED AND COMPLETE.
- ALL CURB RAMPS AND DETECTABLE WARNINGS TO BE INSTALLED IN ACCORDANCE WITH FDOT STANDARD INDEX 304 (LATEST EDITION).
- ALL SIGNS TO BE INSTALLED PER FDOT DESIGN STANDARDS INDEX NO. 600 (LATEST EDITION), AND AS SHOWN ON THE PLANS UNLESS OTHERWISE NOTED.
- ALL PAVEMENT SYMBOLS AND MARKINGS SHALL BE THERMOPLASTIC PAVEMENT MARKINGS UNLESS OTHERWISE NOTED. INSTALLATION AND MATERIALS SHALL MEET ALL REQUIREMENTS OF SECTION 711 OF FDOT STANDARD SPECIFICATIONS FOR ROAD AND BRIDGE CONSTRUCTION.
- ALL PAVEMENT MARKINGS SHALL BE INSTALLED IN ACCORDANCE WITH FDOT STANDARD INDEX NO. 17346 (LATEST EDITION).
- PAINTED PAVEMENT MARKINGS, INSTALLATION AND MATERIALS SHALL MEET ALL REQUIREMENTS OF SECTION 710 OF FDOT STANDARD SPECIFICATIONS FOR ROAD AND BRIDGE CONSTRUCTION, AND THE FOLLOWING:
  - APPLY TWO COATS OF VOC COMPLIANT, LOCAL DOT APPROVED, UNDILUTED SOLVENT BASED OR LATEX TRAFFIC PAINT.
  - FOLLOW MANUFACTURER'S RECOMMENDED APPLICATION RATE, WITHOUT THE ADDITION OF A THINNER, WITH A MAXIMUM OF 100 SF PER GALLON, OR AS REQUIRED, PROVIDING MINIMUM 25 MILS WET FILM THICKNESS AND 7.5 MILS DRY FILM THICKNESS PER COAT WITH MINIMUM OF 30 DAYS BETWEEN APPLICATIONS.
  - SECOND COAT OF PAINT SHALL NOT BE APPLIED EARLIER THAN 7 DAYS PRIOR TO GRAND OPENING.
  - PAINT SHALL BE CRISP, STRAIGHT, AND APPLIED UNIFORMLY ACROSS THE WIDTH OF THE LINE FOR A TOTAL DRY FILM THICKNESS OF 15 MILS.
- CONTRACTOR SHALL NOT ALLOW TRAFFIC ONTO NEWLY APPLIED PAVEMENT STRIPING/MARKINGS UNTIL THEY ARE SUFFICIENTLY DRY TO PERMIT VEHICLES TO CROSS THEM WITHOUT DAMAGE. THE CONTRACTOR SHALL, AT HIS OWN EXPENSE, REMOVE AND REPLACE ANY PORTION OF THE PAVEMENT STRIPING/MARKINGS DAMAGED BY PASSING TRAFFIC OR ANY OTHER CAUSE.
- SIGNS SHALL BE IN ACCORDANCE WITH SECTION NO. 700, HIGHWAY SIGNING, OF THE FDOT STANDARD SPECIFICATIONS FOR ROAD AND BRIDGE CONSTRUCTION.
- TRAFFIC SIGNS SHALL BE INSTALLED IN ACCORDANCE WITH THE U.S. DEPARTMENT OF TRANSPORTATION MANUAL OF UNIFORM TRAFFIC CONTROL DEVICES (MUTCD), PART II, AND IN THE LOCATIONS SHOWN ON PLANS.
- PARKING STALL MARKINGS DEPICTED ON PLAN ARE FOR GRAPHICAL PURPOSES ONLY.
- ALL EXISTING SIGNALIZATION EQUIPMENT TO REMAIN IS ASSUMED TO BE IN GOOD WORKING ORDER UNLESS BCTED IS NOTIFIED IN WRITING PRIOR TO THE START OF CONSTRUCTION. ANY SUBSEQUENT DAMAGE TO THE SIGNAL EQUIPMENT SHALL BE REPAIRED BY THE CONTRACTOR AT THE CONTRACTOR'S EXPENSE.
- INSTALL YELLOW REFLECTIVE PAINT ON ALL MEDIAN NOSES PER BROWARD COUNTY TRAFFIC ENGINEERING DIVISION STANDARDS.
- EXISTING MARKING SHALL BE REMOVED BY WATER BLASTING OR SAND BLASTING ONLY.
- CONTRACTOR TO COORDINATE WITH ARCHITECT PRIOR TO ALL PEDESTRIAN LIGHTS INSTALLATION.
- ALL RADII IS 3' UNLESS OTHERWISE NOTED.

Digitally signed by George Balaban  
Date: 2023.07.12 16:57:33 -04'00'

GEORGE BALABAN, STATE OF FLORIDA, PROFESSIONAL ENGINEER, LICENSE NO. 74543  
THIS ITEM HAS BEEN DIGITALLY SIGN AND SEALED BY GEORGE BALABAN, P.E. ON THE DATE INDICATED HERE.  
PRINTED COPIES OF THE DOCUMENT ARE NOT CONSIDERED SIGNED AND SEALED AND THE SIGNATURE MUST BE VERIFIED ON ANY ELECTRONIC COPIES.

PLANS ARE IN NAVD 1988 DATUM  
CONVERSION EQUATION IS BELOW:  
(NAVD 1988) + 1.58' = (NGVD 1929)

THE PRESENCE OF GROUNDWATER SHOULD BE ANTICIPATED. CONTRACTOR'S BID SHALL INCLUDE CONSIDERATION FOR ADDRESSING THIS ISSUE AND OBTAINING ALL NECESSARY PERMITS.

Always call 811 two full business days before you start to dig to have underground utilities located and marked.  
Sunshine 811.com

Kimley»Horn

© 2023 KIMLEY-HORN AND ASSOCIATES, INC.  
8201 PETERS ROAD, SUITE 2200, PLANTATION, FL 33324  
PHONE: 954-535-5100 FAX: 954-739-2247  
WWW.KIMLEY-HORN.COM REGISTRY No. 35106

LICENSED PROFESSIONAL  
KHA PROJECT  
D44203010  
DATE  
JULY 2023  
SCALE AS SHOWN  
DESIGNED BY TVC  
DRAWN BY TVC  
CHECKED BY GB  
DATE: 07/07/2023

SIGNAGE & MARKING  
PLAN

BREW FISH  
BREWERY  
PREPARED FOR  
CITY OF POMPAHO BEACH  
FL